

26781

| Subarea | Ground Level Elevation (AMSL) | Land Area (sf) | Maximum Subarea Floor Area (sf) | Maximum Subarea Structure Height (ft) | Maximum Lot Coverage (sf) | Minimum Open Space Required (sf) |
|---------|-------------------------------|----------------|---------------------------------|---------------------------------------|---------------------------|----------------------------------|
| A | 465 | 41,915 | 350,000 | 365 | No Maximum | 6,300 |
| B | 452 | 55,636 | 350,000 | 280 | No Maximum | 8,300 |
| C | 450 | 115,764 | 750,000 | 240 | No Maximum | 17,400 |
| D | 445 | 46,522 | 300,000 | 240 | No Maximum | 7,000 |
| E | 458 | 19,872 | 135,000 | 325 | No Maximum | 3,000 |
| F | 455 | 48,932 | 750,000 | Any Legal | No Maximum | 7,300 |
| G | 447 | 83,609 | 500,000 | 225 | No Maximum | 12,500 |
| H | 441 | 32,299 | 225,000 | 350 | No Maximum | 4,800 |
| I | 422 | 52,403 | 500,000 | Any Legal | No Maximum | 7,900 |
| J | 430 | 101,214 | 1,214,567 | Any Legal | No Maximum | 15,200 |
| K | 423 | 123,272 | 1,479,264 | Any Legal | No Maximum | 18,500 |

Harwood District Maximum Floor Area
5,421,380 square feet

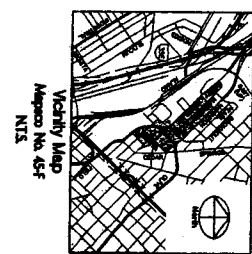
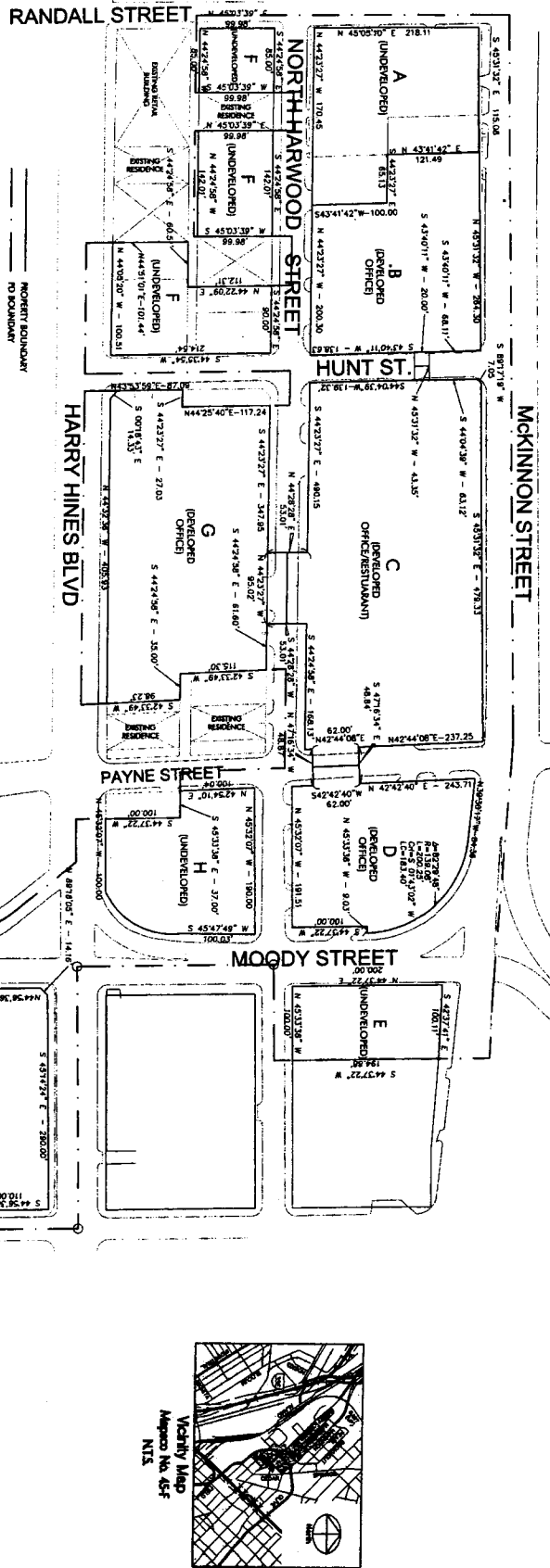

HARWOOD INTERSECTION

Planned Development
District No. 193

PDS No. 79

HARWOOD DISTRICT PDS
CONCEPTUAL PLAN

Approved
City Plan Commission
May 17, 2007



CASE NO. 2067-173 (RB)